

TALYST®



AUTOCAROUSEL HD: **Specification Sheet**

AutoCarousel Heavy Duty:
Secure Automated Storage

AutoCarousel® HD models provide heavy-duty, secure, automated storage for all of your medications. They are easy-to-use, accurate, and their efficient vertical design ensures maximum storage in a compact footprint.

AutoCarousel® HD

Built to last, AutoCarousel HD ensures accurate orders with barcode verification, comprehensive inventory control and a space savings of 30 to 50%.

AutoCarousel is integrated into the complete AutoPharm software-based solution, enabling comprehensive management of your pharmacy inventory from arrival in the pharmacy to delivery to the patient care area.

Improved Patient Safety

- Ensures accurate order filling with pick-to-light indicators and bar code verification
- Enables comprehensive, accurate tracking and control of all stored items
- Provides enhanced security with physical barriers and password-protected access

Precise Control and Access

- On-site assembly and a modular design enables delivery and placement in tight clearances
- Allows emergency access to items with a backup motor and manual foot pedal
- Includes multiple safeties: E-stop touch button, infrared photo eyes, access panel interlock switch, and motor overload stop

Enhanced Efficiency

- Allows you to reclaim pharmacy space by decreasing your required storage space by 30% to 50%
- Reduces the number of staff and number of hours required to stock items and fill orders
- Streamlines your returns process; just scan the item, enter the quantity, and scan the light-designated bin to safely return the item

AUTOCAROUSEL HD: Dimensions

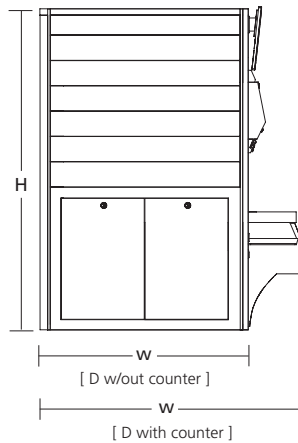
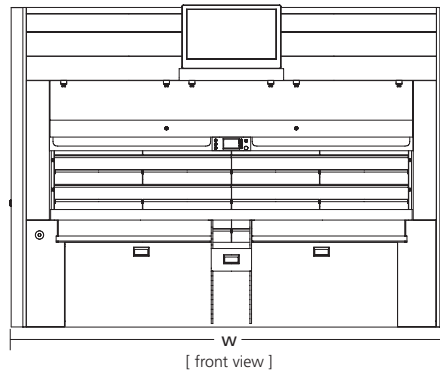

AUTOCAROUSEL HD: Bin Dimensions

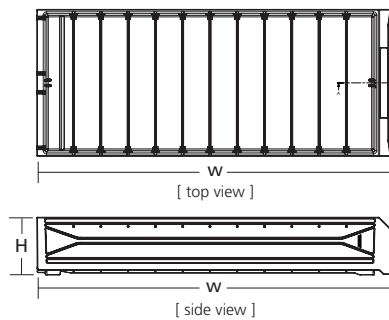
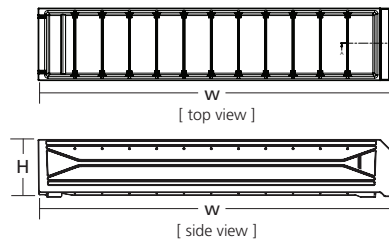

AUTOCAROUSEL HD: Standard Model Specifications

DIMENSIONS	HD-8S	HD-10S	HD-12S	HD-14S	HD-16S	HD-14SXL	HD-12N	HD-12XN	HD-16XN
Height (H)	84"	96"	107.8"	119.8"	131.8"	142.8"	107.2"	102.75"	126.75"
Width (W)	148.8"	148.8"	148.8"	148.8"	148.8"	148.8"	129.9"	119.7"	119.7"
Depth w/o Work Counter	73"	73"	73"	73"	73"	73"	73"	62.13"	62.13"
Depth w/ Work Counter	91.2"	91.2"	91.2"	91.2"	91.2"	91.2"	91.2"	80.5"	80.5"
Counter Depth	15.75"	15.75"	15.75"	15.75"	15.75"	15.75"	15.75"	15.75"	15.75"
Carousel Weight Unloaded	4,471 lbs	5,051 lbs	5,630 lbs	6,299 lbs	6,879 lbs	7,040 lbs	5,159 lbs	4,488 lbs	5,878 lbs
Carousel Weight at Max Load	7,991 lbs	9,451 lbs	10,910 lbs	12,459 lbs	13,919 lbs	13,200 lbs	10,439 lbs	9,768 lbs	12,918 lbs
Occupied Floor Space	94.25 ft ²	94.25 ft ²	94.25 ft ²	94.25 ft ²	94.25 ft ²	94.25 ft ²	82.27 ft ²	66.9 ft ²	66.9 ft ²
STORAGE CAPACITY	HD-8S	HD-10S	HD-12S	HD-14S	HD-16S	HD-14SXL	HD-12N	HD-12XN	HD-16XN
Number of Pans	8	10	12	14	16	14	12	12	16
Number of Shelves	16	20	24	28	32	28	24	24	32
Carrier Spacing (Pitch)	12"	12"	12"	12"	12"	15"	12"	12"	12"
Useable Height per Pan	10"	10"	10"	10"	10"	12.7"	9.84"	10"	10"
Useable Width per Pan	119.7"	119.7"	119.7"	119.7"	119.7"	119.7"	100"	90.6"	90.6"
Useable Depth per Pan	24.4"	24.4"	24.4"	24.4"	24.4"	24.4"	24.4"	18.5"	18.5"
Maximum Load per Pan	440 lbs	440 lbs	440 lbs	440 lbs	440 lbs	440 lbs	440 lbs	440 lbs	440 lbs
Usable Width per Shelf	119.7"	119.7"	119.7"	119.7"	119.7"	119.7"	100"	90.6"	90.6"
Usable Depth per Shelf	24.4"	24.4"	24.4"	24.4"	24.4"	24.4"	24.4"	18.5"	18.5"
Usable Unit Cube / Carousel	135.2 ft ³	169 ft ³	202.8 ft ³	236.6 ft ³	270.4 ft ³	300.5 ft ³	167 ft ³	116.4 ft ³	155.2 ft ³
Storage Area per Carousel	324.5 ft ²	405.6 ft ²	486.7 ft ²	567.8 ft ²	648.9 ft ²	567.9 ft ²	406.8 ft ²	279.4 ft ²	372.5 ft ²
BINS & DIVIDERS	HD-8S	HD-10S	HD-12S	HD-14S	HD-16S	HD-14SXL	HD-12N	HD-12XN	HD-16XN
Tote A – Narrow: 15.7" x 4.5" x 3.9"	–	–	–	–	–	–	–	205	340
Tote A – Wide: 15.7" x 9.1" x 3.9"	–	–	–	–	–	–	–	139	170
Narrow Bin Divider: 4.5"	–	–	–	–	–	–	–	1040	1360
Wide Bin Divider: 9.1"	–	–	–	–	–	–	–	520	680
Total Equivalent NDC Compartments	–	–	–	–	–	–	–	1,950	2550
Tote B – Narrow: 23.9" x 4.9" x 3.9"	164	216	268	320	350	320	200	–	–
Tote B – Wide: 23.9" x 9.9" x 3.9"	110	132	154	176	209	176	140	–	–
Narrow Bin Divider: 4.9"	656	864	1,072	1,280	1,400	1,280	800	–	–
Wide Bin Divider: 9.9"	330	396	462	528	627	528	420	–	–
Total Equivalent NDC Compartments	1,260	1,608	1,956	2,304	2,586	2,304	1,560	–	–

NOTE: Dimensions are approximate. A site survey will be required for final carousel dimensions.
The site survey will also confirm there are no physical obstructions that would affect installation.

Additional sizes available, contact Talyst directly for more information.

AUTOCAROUSEL HD: Standard Model Specifications

SAFETY	HD-8S	HD-10S	HD-12S	HD-14S	HD-16S	HD-14SXL	HD-12N	HD-12XN	HD-16XN
Emergency Backup Motor w/ Foot Pedal	Yes	Yes	Yes	Yes	Yes	Yes	Yes	Yes	Yes
E-stop	Yes	Yes	Yes	Yes	Yes	Yes	Yes	Yes	Yes
Infrared Photo Eyes	Yes	Yes	Yes	Yes	Yes	Yes	Yes	Yes	Yes
Access Panel Interlock Switch	Yes	Yes	Yes	Yes	Yes	Yes	Yes	Yes	Yes
FEATURES	HD-8S	HD-10S	HD-12S	HD-14S	HD-16S	HD-14SXL	HD-12N	HD-12XN	HD-16XN
Color	Grey	Grey	Grey	Grey	Grey	Grey	Grey	Grey	Grey
Work Surface (Pick Window)	Stainless Steel	Stainless Steel	Stainless Steel	Stainless Steel	Stainless Steel	Stainless Steel	Stainless Steel	Stainless Steel	Stainless Steel
Lockable Pick Window	Yes	Yes	Yes	Yes	Yes	Yes	Yes	Yes	Yes
Centrally located Operator Interface	Yes	Yes	Yes	Yes	Yes	Yes	Yes	Yes	Yes
Control Interface (type)	RS-232 Serial	RS-232 Serial	RS-232 Serial	RS-232 Serial	RS-232 Serial	RS-232 Serial	RS-232 Serial	RS-232 Serial	RS-232 Serial
Operator Display	Ergotron® Arm, Right Side	Ergotron® Arm, Right Side	Ergotron® Arm, Right Side	Ergotron® Arm, Right Side	Ergotron® Arm, Right Side	Ergotron® Arm, Right Side	Ergotron® Arm, Right Side	Ergotron® Arm, Right Side	Ergotron® Arm, Right Side
Operator Lighting	LED	LED	LED	LED	LED	LED	LED	LED	LED
Frame—modular design	Yes	Yes	Yes	Yes	Yes	Yes	Yes	Yes	Yes
OPERATION	HD-8S	HD-10S	HD-12S	HD-14S	HD-16S	HD-14SXL	HD-12N	HD-12XN	HD-16XN
Speed (inches / second)	5.21	5.21	5.21	5.21	5.21	5.21	5.21	5.21	5.21
Average Access Time (1/4 revolution of carousel)	4.60 sec	5.76 sec	6.91 sec	8.07 sec	9.21 sec	10.08 sec	6.91 sec	6.91 sec	9.21 sec
Maximum Imbalance Load	unlimited	unlimited	unlimited	unlimited	unlimited	unlimited	unlimited	unlimited	unlimited
Drive Type (horsepower)	3	3	3	3	3	3	3	3	3
POWER REQUIREMENTS	HD-8S	HD-10S	HD-12S	HD-14S	HD-16S	HD-14SXL	HD-12N	HD-12XN	HD-16XN
Main Power	1-phase 120-240V 20amp (include neutral and ground)	1-phase 120-240V 20amp (include neutral and ground)	1-phase 120-240V 20amp (include neutral and ground)	1-phase 120-240V 20amp (include neutral and ground)	1-phase 120-240V 20amp (include neutral and ground)	1-phase 120-240V 20amp (include neutral and ground)	1-phase 120-240V 20amp (include neutral and ground)	1-phase 120-240V 20amp (include neutral and ground)	1-phase 120-240V 20amp (include neutral and ground)
Power Requirements Duplex and Quad	120 @ 15amp	120 @ 15amp	120 @ 15amp	120 @ 15amp	120 @ 15amp	120 @ 15amp	120 @ 15amp	120 @ 15amp	120 @ 15amp
Duty Cycle	100%	100%	100%	100%	100%	100%	100%	100%	100%
BTU (max)	1908	1908	1908	1908	1908	1908	1908	1908	1908